

MODEL Q LABORATORY STAND

Operator Instructions

TEL 508-946-6200 or 800-628-8139 FAX 508-946-6262
www.brookfieldengineering.com



CAUTION: This is a spring-loaded, non-serviceable device. Do not disassemble the clamp and upright rod assembly.

UNPACKING

Check to see that all the components are received with no concealed damage:

- 1 VSQA-001Y clamp and upright rod assembly
- 1 VS-2Y Base with two leveling screws, one mounting screw and washer

ASSEMBLY

Remove the mounting screw and washer from the upright rod. Place the rod and clamp assembly into the hole in the top of the base with the release lever facing forward. NOTE: Slot at the bottom of the rod must line up with the pin in the hole. Fasten mounting screw and washer to the upright rod. Tighten with a flathead screwdriver. To fully tighten the rod to the base, a torque of 30 inch•pounds (3.5 Newton•meters) is typically recommended.

VISCOMETER MOUNTING

Insert the viscometer rod into the cutaway slot of the clamp assembly. Adjust the instrument until the viscometer/rheometer bubble level is centered and tighten the clamp knob. Use the base leveling screws to "fine" adjust the instrument level.

OPERATING THE LAB STAND

Push and hold release lever on the clamp assembly (see illustration at right). Move viscometer/rheometer head to desired height and release lever.

Elevate your sample container, if necessary, to ensure that the proper spindle immersion is achieved.

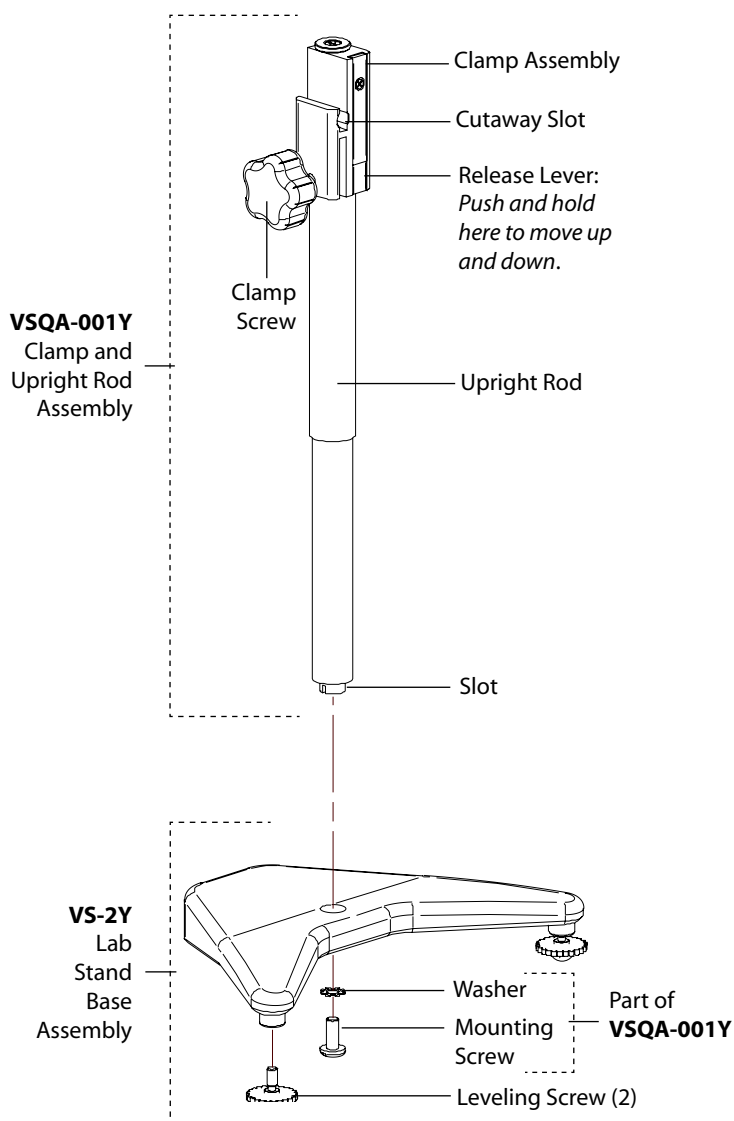

ANALIS sa/nv
PHYSTEST@ANALIS.BE
Tel ++ 32 (0) 9 243 77 21
www.analis.be